



Ansty Drive | Heath Hayes, Cannock | WS12 3TZ

Offers In The Region Of £240,000



Summary

**** NO CHAIN ** MOTIVATED SELLER ****

**DESIRABLE LOCATION ** THREE BEDROOMS ** EXCELLENT SCHOOL CATCHMENTS ** MODERN STYLE KITCHEN ** TWO RECEPTION ROOMS ** UTILITY AND GUEST WC ** ENCLOSED REAR GARDEN ** EXCELLENT TRANSPORT LINKS ** VIEWING STRONGLY ADVISED **

Webbs Estate Agents are pleased to offer for sale a well-presented link detached home, set in the highly popular location of Heath Hayes offering excellent schools, transport links, shops and amenities.

In brief consisting of an entrance porch, a spacious lounge, a dining room with double doors opening out onto the rear garden, a modern kitchen, utility room, guest WC and an integral garage.

To the first floor there are three bedrooms and a family bathroom, externally the property has an enclosed rear garden with ample off-road parking provided by a single garage and driveway, EARLY VIEWING ESSENTIAL

Key Features

- MODERN LINK DETACHED HOME
- EXCELLENT SCHOOL CATCHMENTS
- UTILITY AND GUEST WC
- DINING ROOM
- ENCLOSED REAR GARDEN
- THREE BEDROOMS
- SPACIOUS LOUNGE
- POPULAR LOCATION
- MODERN KITCHEN
- VIEWING ADVISED

Rooms and Dimensions

ENTRANCE PORCH

SPACIOUS LOUNGE

15'0" x 11'11" (4.58 x 3.64)

DINING ROOM

12'9" x 8'0" (3.90 x 2.45)

MODERN KITCHEN

12'6" x 6'6" (3.82 x 1.99)

UTILITY ROOM

GUEST WC

SINGLE INTEGRAL GARAGE

LANDING

BEDROOM ONE

11'1" x 10'1" (3.40 x 3.08)

BEDROOM TWO

10'1" x 9'7" (3.08 x 2.94)

BEDROOM THREE

8'7" x 5'10" (2.62 x 1.79)

FAMILY BATHROOM

ENCLOSED REAR GARDEN





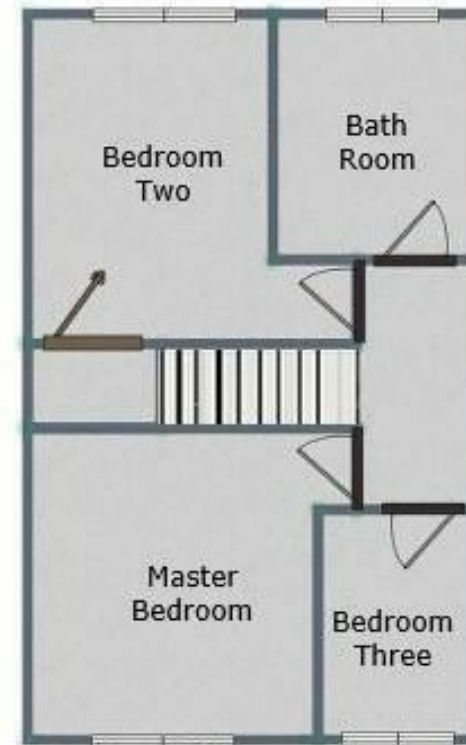

FOR ILLUSTRATIVE PURPOSES ONLY, NOT TO SCALE

Webbs Estate Agents - endeavour to maintain accurate depictions of properties in Virtual Tours, Floor Plans and descriptions, however, these are intended only as a guide and purchasers must satisfy themselves by personal inspection.

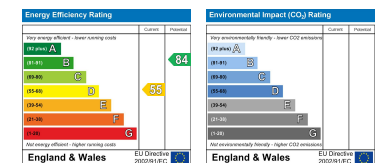

153 Avon Road, Cannock, WS11 1LF

Tel: 01543 468846 | Email: sales@webbestateagents.co.uk | www.webbestateagents.co.uk